

## Shackles, SAE - dee mode with locking

---

### Product information



Shackles approved for lifting. Dee shackles are suitable for use when two pieces of lifting equipment / an installment are joined together (one-leg systems). Locking bolt shackles are recommended for long-term and permanent installations, or when there is a natural tendency for the pin to unscrew (rotate) in the application, or when the shackle cannot be observed under operation.

... [Read more](#)

---

**Features:** RFID-ready

**Material:** Steel

**Marking:** According to standard, CE-marked

**Temperature range:** -20°C - (+)200°C

**Finish:** Hot dip galvanized

**Standard:** US. FED. SPEC. RR-C-271F

**Safety factor:** 6:1

## Shackles, SAE - dee mode with locking

### Blueprint

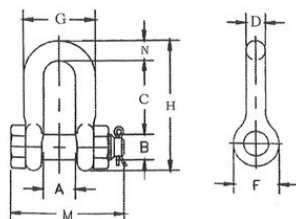

### Technical data

Part code	WLL ton	Size inch	A mm	B mm	C mm	D mm	F mm	G mm	H mm	M mm	N mm	Weight kg
SAK05SLBP	0.5	1/4	12	8	19	7	16	25	41	40	7	0.06
SAK07SLBP	0.75	5/16	14	10	26	8	19	30	49	46	8	0.1
SAK10SLBP	1	3/8	17	11	31	10	23	36	59	55	10	0.15
SAK15SLBP	1.5	7/16	19	13	36	11	27	41	68	64	11	0.22
SAK20SLBP	2	1/2	21	16	42	13	30	46	77	71	13	0.34
SAK32SLBP	3.25	5/8	27	19	51	16	38	59	96	90	16	0.67
SAK47SLBP	4.75	3/4	32	23	61	19	46	70	115	103	21	1.14
SAK65SLBP	6.5	7/8	37	26	72	23	53	81	135	120	25	1.74
SAK85SLBP	8.5	1	43	29	81	26	61	94	151	135	26	2.52
SAK95SLBP	9.5	1-1/8	46	32	91	29	69	103	172	150	32	3.45
SAK120SLBP	12	1-1/4	52	35	100	32	76	115	191	165	35	4.9
SAK135SLBP	13.5	1-3/8	57	38	111	35	84	127	210	183	38	6.24
SAK170SLBP	17	1-1/2	61	42	122	38	92	137	230	196	42	8.39
SAK250SLBP	25	1-3/4	73	51	146	45	106	162	279	230	54	14.2
SAK350SLBP	35	2	82	57	172	51	122	184	312	264	51	21.2
SAK550SLBP	55	2-1/2	105	70	203	67	145	238	377	344	67	38.6
SAK850SLBP	85	3	127	83	216	76	165	279	429	419	89	56
SAK1200SLBP	120	3-1/2	133	96	240	92	203	320	500	510	102	95