

## Turnbuckles closed frame with stubs DIN 1478

---

### Product information

Commercial quality turnbuckles with weldable stubs for all kind of use.

... [Read more](#)

---

**Material:** Steel

**Finish:** Electro galvanized

**Note:** Not for lifting



## Turnbuckles closed frame with stubs DIN 1478

### Blueprint

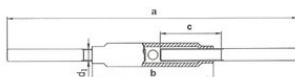

### Technical data

Part code	Length range	Thread	a mm	b mm	c mm	Weight kg
VRRUT06	240-330	M6	240 – 330	110	65	0.14
VRRUT08	240-325	M8	240 – 325	110	65	0.18
VRRUT10	300-395	M10	300 – 395	125	75	0.32
VRRUT12	300-390	M12	300 – 390	125	75	0.45
VRRUT16	400-520	M16	400 – 520	170	100	0.9
VRRUT20	400-540	M20	400 – 540	200	120	1.5
VRRUT24	520-700	M24	520 – 700	255	150	2.75
VRRUT30	520-680	M30	520 – 680	255	160	3.94
VRRUT36	600-780	M36	600 – 780	295	180	6.5